

### Important Information

We recommend that luminaires are installed by a qualified electrician ensuring the installation complies with current IEE wiring regulations BS7671:2018 & local building control.

### Suggested method of installation

Read the instructions and check that you have all the tools and accessories to complete the installation correctly.

- Step 1.** Isolate the mains supply before connecting the fitting.
- Step 2.** Screw the surface clips in the desired position for your fitting
- Step 3.** Push the luminaire on to the clips you secured in step 2.
- Step 4.** Plug in mains power supply.
- Step 5.** Terminate mains power supply
- Step 6.** If you have more than one fitting, use the link adapters to join fittings.
- Step 7.** Use the end of run blank to close off termination on the final fitting.
- Step 8.** Restore mains power.

This product may contain substances that can be hazardous to the environment if not disposed of properly. Electrical and electronic equipment should never be disposed of with general household waste but must be separated for its correct treatment and recovery.

Where possible recycle your packaging.



Read these instructions before installation and retain for future reference

This equipment should be installed by a competent electrician

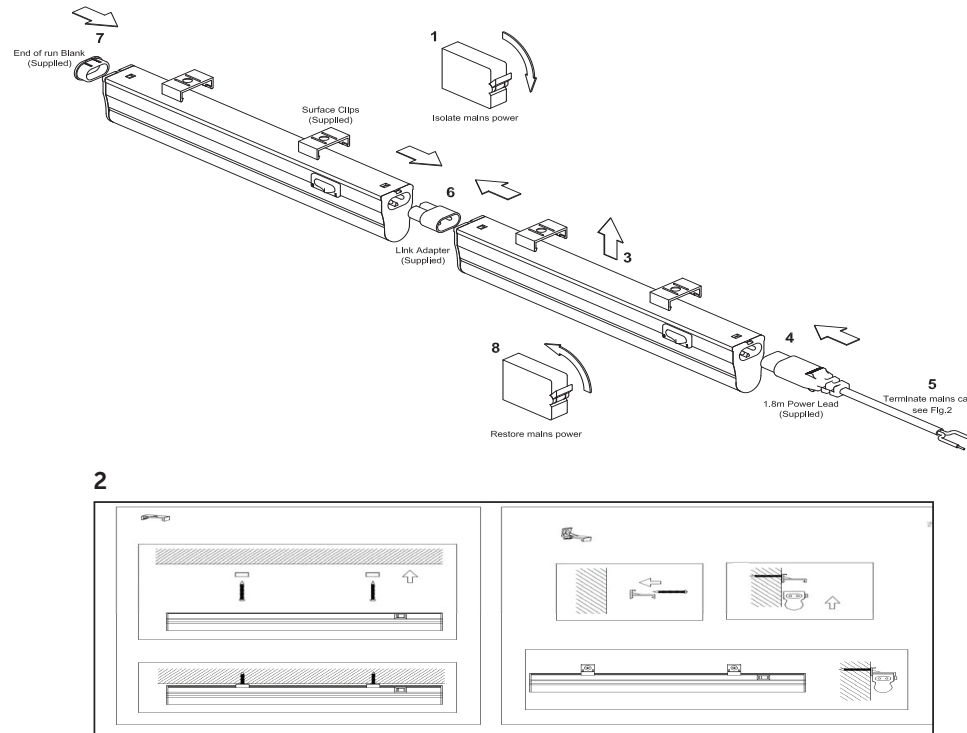

Code	W	lm	lm/W	Dimensions
07160/4	4	300	175	313x28x36mm
07161/5	8	600	175	573x28x36mm
07162/6	11	900	82	873x28x36mm
07163/7	14	1100	178	1137x28x36mm

### Mains connection of the luminaire

Primary 240V 50Hz. Class II

**Wire Brown - connect to Live (L)**  
**Wire Blue - connect to Neutral (N)**

This luminaire is double insulated

### Guarantee

This product is guaranteed for a period of **5 years** from the date of purchase. The guarantee is invalid in the case of improper use, improper installation or tampering. Should the product fail during the guarantee period it will be replaced free of charge subject to return of the faulty unit. BELL is not responsible for any costs associated with the replacement of the product.