

Important Information

We recommend that luminaires are installed by a qualified electrician ensuring the installation complies with current IEE wiring regulations BS7671:2018 & local building control.

- BELL will not accept responsibility for any claims arising from a poor installation.
- The light source of this luminaire is not replaceable: when the light source reaches end of life, the whole luminaire must be replaced.

Warning Before installation ensure power is disconnected

- Connect as shown in wiring diagram below.

| | | |
|-------|--------------|-------|
| L | brown | black |
| N | blue | white |
| ⊕ GND | yellow/green | green |

Dimmable 1-10v

| | |
|------|--------|
| DIM+ | purple |
| DIM- | grey |

This product may contain substances that can be hazardous to the environment if not disposed of properly. Electrical and electronic equipment should never be disposed of with general household waste but must be separated for its correct treatment and recovery.

Where possible recycle your packaging.



Read these instructions before installation and retain for future reference

This equipment should be installed by a competent electrician



A. Wire Suspension Installation

Physical Dimensions(Unit: mm)

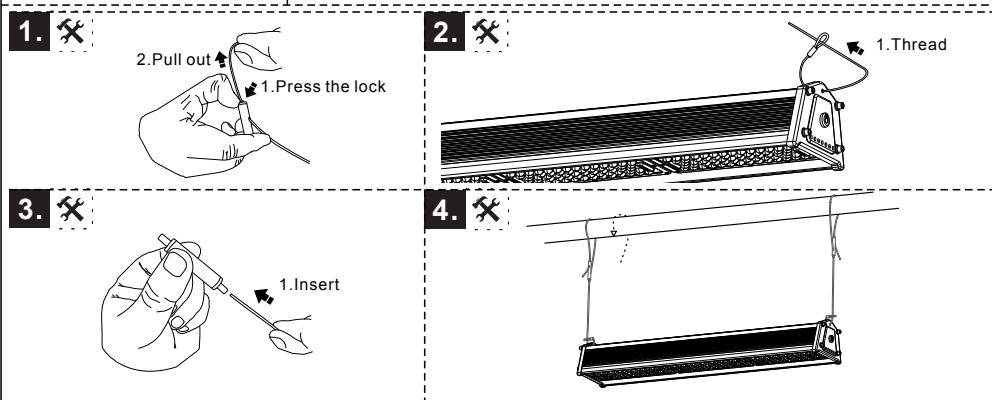
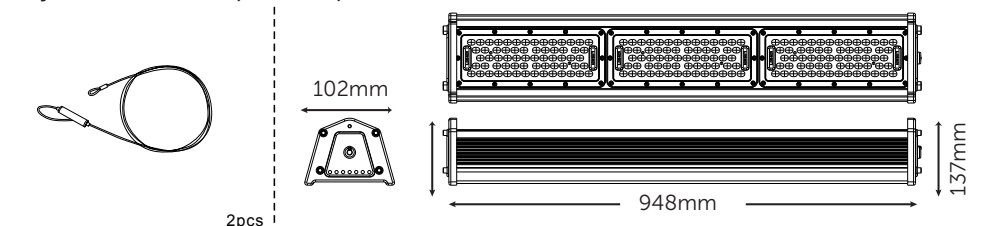

Dimming Function (Sensor Versions)

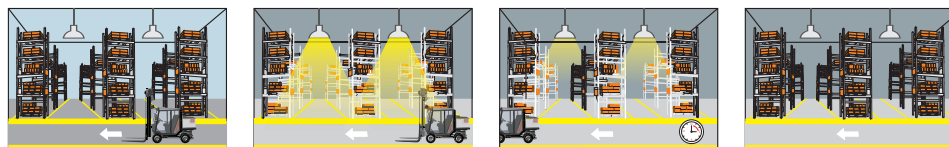

With sufficient ambient light, the sensor does not switch on the lamp.

With insufficient ambient light, the sensor switches on the lamp when motion is detected.

After hold time, the sensor dims the lamp at a low light level if no new motion trigger.

After stand-by period, the sensor switches off the lamp if no motion is detected in its detection zone.

Detection Plan

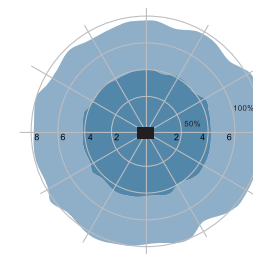

Technical Specification

| | |
|--------------------|-------------------|
| Input Voltage | AC 100-240V |
| Power Frequency | 50/60 Hz |
| Outlook Dimensions | 948 x 137 x 102mm |
| Net Weight | 5.7 Kg |
| Working Temp | -30° to +50° C |
| Storing Temp | -40° to +70° C |

Settings

By selecting the combination on the DIP switch, sensor data can be precisely set for each application.

Detection Area

Detection area can be reduced by selecting the combination of the DIP switches for each application.

| On | | 1 | |
|----|----|------|--|
| I | On | 100% | |
| II | - | 50% | |

Hold Time

Refers to the time period the lamp remains at 100% illumination after no motion is detected.

| On | | 2 | 3 | 4 | |
|-----|----|----|----|----|--------|
| I | On | On | On | On | 5 Sec |
| II | - | On | On | On | 30 Sec |
| III | On | - | On | On | 60 Sec |
| IV | - | - | On | On | 3 Min |
| V | On | On | - | On | 20 Min |
| VI | - | - | - | On | 30 Min |

Stand By Period

Refers to the time the fitting remains at a low light level before it completely switches off. When set to disable mode the low light level is maintained until motion is detected

| On | | 1 | 2 | 3 | |
|-----|----|----|----|----|--------|
| I | On | On | On | On | 0 |
| II | - | On | On | On | 1 Min |
| III | On | - | On | On | 3 Min |
| IV | - | - | On | On | 10 Min |
| V | On | On | - | On | 30 Min |
| VI | - | - | - | On | ∞ |

Stand By Dimming Level

The low light dimming level you would like to have after the hold time in the absence of people.

| On | | 4 | 5 | |
|-----|----|----|----|-----|
| I | On | On | On | 10% |
| II | On | - | On | 20% |
| III | - | On | On | 30% |
| IV | - | - | On | 50% |

Daylight Sensor

The sensor can be set to only allow the fitting to illuminate below a defined ambient light level.

When set to disable mode, the daylight sensor will switch on the fitting when motion is detected regardless of ambient light level.

Note: the daylight sensor is active only when the lamp is switched off.

| On | | 6 | 7 | 8 | 9 | |
|-----|----|----|----|----|----|---------|
| I | On | On | On | On | On | 5 Lux |
| II | - | On | On | On | On | 15 Lux |
| III | On | - | On | On | On | 30 Lux |
| IV | - | - | On | On | On | 50 Lux |
| V | On | On | - | On | On | 100 Lux |
| VI | On | On | On | - | On | 150 Lux |
| VII | - | - | - | - | On | Disable |