



Read these instructions before installation and retain for future reference This equipment should be installed by a competent electrician

Important Information

We recommend that luminaires are installed by a qualified electrician ensuring the installation complies with current IEE wiring regulations BS7671:2018 & local building control.

- BELL will not accept responsibility for any claims arising from a poor installation.
- The light source of this luminaire is not replaceable: when the light source reaches end of life, the whole luminaire must be replaced.
- Always switch off mains supply before installing.

This product may contain substances that can be hazardous to the environment if not disposed of properly. Electrical and electronic equipment should never be disposed of with general household waste but must be separated for its correct treatment and recovery. Where possible recycle your packaging.

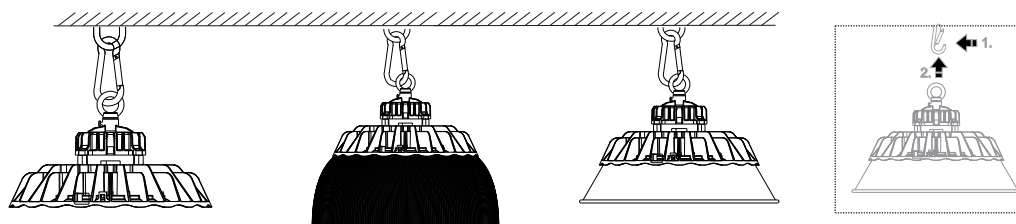

Physical Dimensions (Unit: mm)

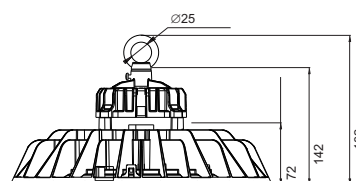
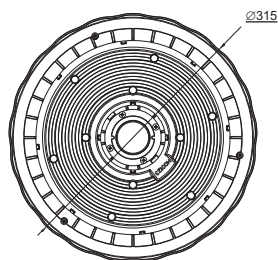

200W

Adjustable power

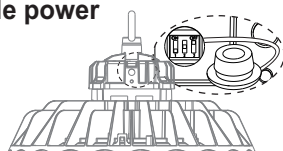

ON	1	2	3	
	●	○	○	200W
	○	●	○	150W
	○	○	●	120W
	○	○	○	100W
OFF				

Max. 200W

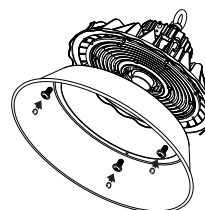
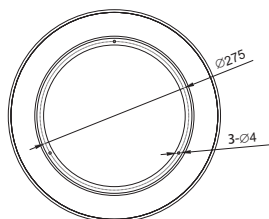
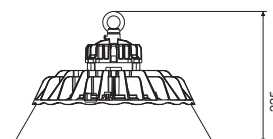



Read these instructions before installation and retain for future reference This equipment should be installed by a competent electrician

Important Information

We recommend that luminaires are installed by a qualified electrician ensuring the installation complies with current IEE wiring regulations BS7671:2018 & local building control.

- BELL will not accept responsibility for any claims arising from a poor installation.
- The light source of this luminaire is not replaceable: when the light source reaches end of life, the whole luminaire must be replaced.
- Always switch off mains supply before installing.

This product may contain substances that can be hazardous to the environment if not disposed of properly. Electrical and electronic equipment should never be disposed of with general household waste but must be separated for its correct treatment and recovery. Where possible recycle your packaging. 

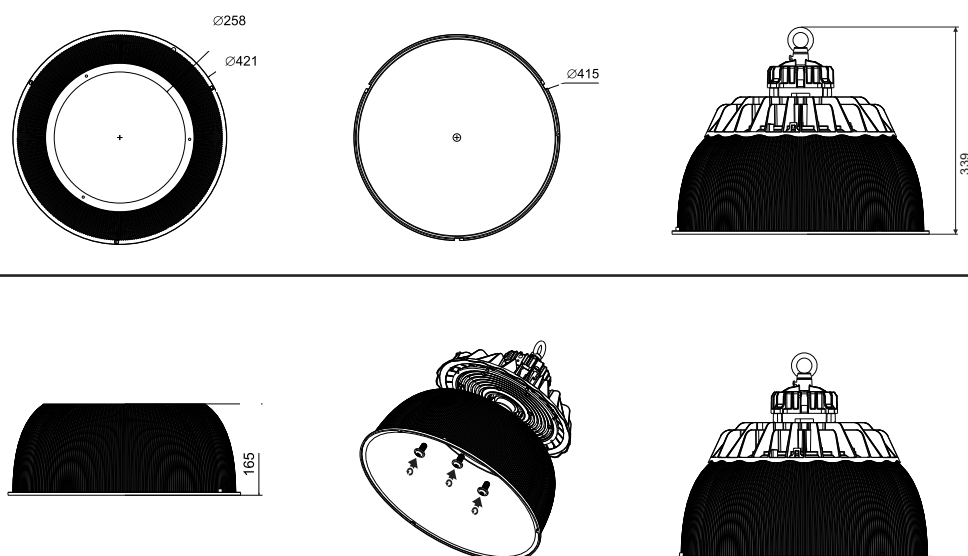

Product Specifications	150W/200W
Size (L x W x H)	Ø315x195
Weight (Driver included)	5±0.3kg(11.02±0.66Lbs)
Input Voltage	100-240V
Working Temperature	-30°C to + 45°C
Storing Temperature	-40° C to +70° C

Wiring diagram for the LED strip:

- L (Line):** Connected to brown and black pins.
- N (Neutral):** Connected to blue and white pins.
- GND (Ground):** Connected to yellow/green and green pins.
- DIM+ / DA1:** Connected to blue, brown, purple, and white pins. Labeled "Dimmable".
- DIM- / DA2:** Connected to white, blue, gray, and black pins.