

# Installation Instructions: Wall Light (10430-10433)

## Important Information

We recommend that luminaires are installed by a qualified electrician ensuring the installation complies with current IEE wiring regulations BS7671:2018 & local building control.

## Important User Advice

- Before installation/maintenance ensure that all mains supply to the luminaire is switched off and the circuit fuses are removed or switched off.
- Installation of this luminaire should only be carried out by a qualified electrician to the current IEE Wiring and Building regulations
- This unit should be used as a fixed luminaire and is not portable.
- Check that the total load on the circuit including when this luminaire is fitted does not exceed the rating of the circuit cable, fuse or circuit breaker.
- This product is IP44 rated and suitable for internal or external applications (PIR version for external use only).
- 230V 50Hz. This unit is Class II double insulated and is not required to be earthed.

This product may contain substances that can be hazardous to the environment if not disposed of properly. Electrical and electronic equipment should never be disposed of with general household waste but must be separated for its correct treatment and recovery.

Where possible recycle your packaging.



Read these instructions before installation and retain for future reference

This equipment should be installed by a competent electrician



## Installation

- Remove the 2 screws 1 x top and 1 x bottom, and remove the steel fascia.
- Remove the 6 screws around the plastic front cover plastic.
- Using the screws provided secure the fixture, ensure correct fixings are used; certain surfaces may require specialist fixings.
- Connect the mains input cable to the pre-wired connector block, ensure correct polarity is observed as per the diagram opposite.
- Fit lamp E27 40W Max.
- Replace cover and fascia.
- Test for correct operation.

## PIR Specification

- Rated load: MAX. 150W
- Detection range: 90 degrees
- Detection distance: MAX 6m ( < 24°C)
- Time Setting: 10 ± 5 sec - 7 ± 2 min (adjustable)
- Ambient Light: 3 - 2000 lux (adjustable)
- Working Temperature: -10°C - +40° C

## PIR Specification



A: Lux Setting (to activate PIR)  
3 - 2000 lux



B: Time Duration  
10 sec - 7 min

## Cleaning & Maintenance

- Clean with a soft dry cloth only, do not use other materials or solutions which may damage the fitting.
- This fixture must not be located near a marine or coastal environment or where there is high salt or sulphur content in the air.

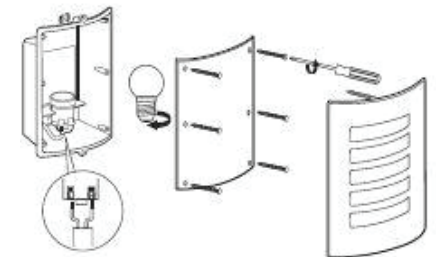
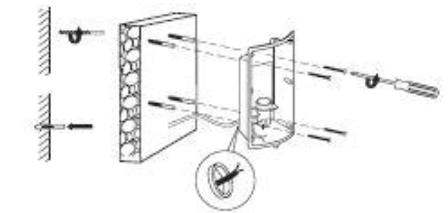

Technical Helpline +44 (0)1924 893380

www.belllighting.co.uk

British Electric Lamps Ltd  
Unit A Foxbridge Way, Normanton Industrial Estate  
Normanton, West Yorkshire. WF6 1TN

T: +44 (0)1924 893380 F: +44 (0)1924 894320 E: sales@belllighting.co.uk

www.belllighting.co.uk