



LED Round Panel

- Super slimline profile
- Remote Micro Driver
- Complete range covering sizes 146mm - 300mm
- Cool White 4000K
- Flicker Free Driver to ensure safety in public areas
- 30000 Hours
- 0-10V dimming or DALI dimming options available
- Emergency panels with 3 year battery guarantee available



Surface Mount models available



Emergency versions must be tested in line with the requirements of BS5266, failure to do so may effect battery life and warranty.

Code	W	Description	Lm	Temp	Hours
09730	9	Ø 146mm Arial Round LED Panel	630	4000K	30000
09729	12	Ø 170mm Arial Round LED Panel	1130	4000K	30000
09731	15	Ø 190mm Arial Round LED Panel	1520	4000K	30000
09732	18	Ø 225mm Arial Round LED Panel	1800	4000K	30000
09733	24	Ø 300mm Arial Round LED Panel	2430	4000K	30000
09695	9	Ø 146mm Arial Round LED Panel - Emergency	630	4000K	30000
09696	12	Ø 170mm Arial Round LED Panel - Emergency	1130	4000K	30000
09697	15	Ø 190mm Arial Round LED Panel - Emergency	1520	4000K	30000
09698	18	Ø 225mm Arial Round LED Panel - Emergency	1800	4000K	30000
09699	24	Ø 300mm Arial Round LED Panel - Emergency	2430	4000K	30000
09744	9	Ø 146mm Arial Round LED Panel - 0-10v Dim	630	4000K	30000
09745	12	Ø 170mm Arial Round LED Panel - 0-10v Dim	1130	4000K	30000
09746	15	Ø 190mm Arial Round LED Panel - 0-10v Dim	1520	4000K	30000
09747	18	Ø 225mm Arial Round LED Panel - 0-10v Dim	1800	4000K	30000
09748	24	Ø 300mm Arial Round LED Panel - 0-10v Dim	2430	4000K	30000
09739	9	Ø 146mm Arial Round LED Panel - Dali Dim	630	4000K	30000
09740	12	Ø 170mm Arial Round LED Panel - Dali Dim	1130	4000K	30000



Technical Specification

Data	
Construction	Aluminium + PMMA
Driver	BELL
LED Chip	Philips
IP Rating	IP44 Standard / IP20 Surface Mounted Version
Operating Temp	0°C to +35°C
Input Voltage	220 - 240V
Power Factor	> 0.9
CRI	85 - Exceeds EU standard of Ra 80 for Colour Rendering Index
LMR	80 - Exceeds EU standard of 70 for Lumens Maintenance Ratio
L1A / L1B / L2A / L2B Compliant	No
Emergency Battery Type	NiCd

* All BELL Lighting luminaires are rated L80 B10, so for a 50,000 hour product. L80B10 at 50,000 hours our fittings will still have 80% of initial lumen, only 10% of fittings will fail to achieve this.

09734 9W

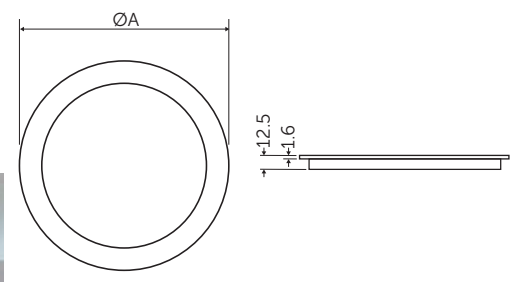

Model	A	Cut-Out
9W	146mm	130mm
12W	170mm	160mm
15W	190mm	180mm
18W	225mm	210mm
24W	300mm	282mm

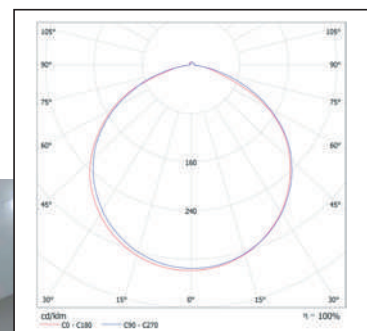

Code	W	Description	Lm	Temp	Hours
09741	15	Ø 190mm Arial Round LED Panel - Dali Dim	1520	4000K	30000
09742	18	Ø 225mm Arial Round LED Panel - Dali Dim	1800	4000K	30000
09743	24	Ø 300mm Arial Round LED Panel - Dali Dim	2430	4000K	30000
09750	18	Ø 240mm Arial Round LED Panel - Surface Mounted	630	4000K	30000
09751	24	Ø 300mm Arial Round LED Panel - Surface Mounted	2430	4000K	30000

Available on request:

- Emergency panels with 3 year battery guarantee (exc Surface Mounted)
- Emergency 0-10v Dim
- Emergency Dali Dim

For further information call 01924 893380 or email sales@belllighting.co.uk



¹ Exceeds EU standard of 70 for Lumens Maintenance Ratio
² Exceeds EU standard of RA 80 for Colour Rendering Index
³ Subject to terms & conditions (Contact Customer Service)